

SMALL DOUBLE SIDED VINYL BANNER

901.05

BANNERS & FLAGS

REVIEWED: 08.03.2024

THESE BANNERS ARE USED ON
FOOTPATHS IN THE FOLLOWING
LOCATIONS:

H1 - 10 BANNERS ON HAY ST
T2.5 - 10 BANNERS ON ADELAIDE TCE
R1 - 17 BANNERS ON ROE ST
R2 - 6 BANNERS ON ROE ST
R3 - 24 BANNERS ON ROE ST

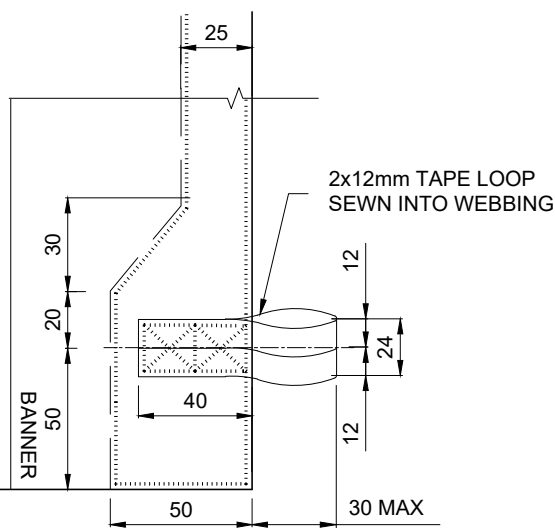
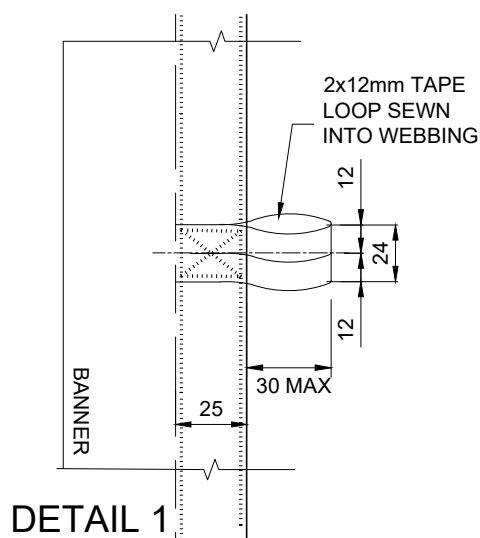

THICK VINYL LINER WITHIN POCKET WITH
HEAVY DUTY CLOSURE AT CLOSED END TO
BE INCORPORATED INTO BANNER STITCHING
AND MATERIAL TO PREVENT THE CLOSED
END OF THE POCKET FROM OPENING.

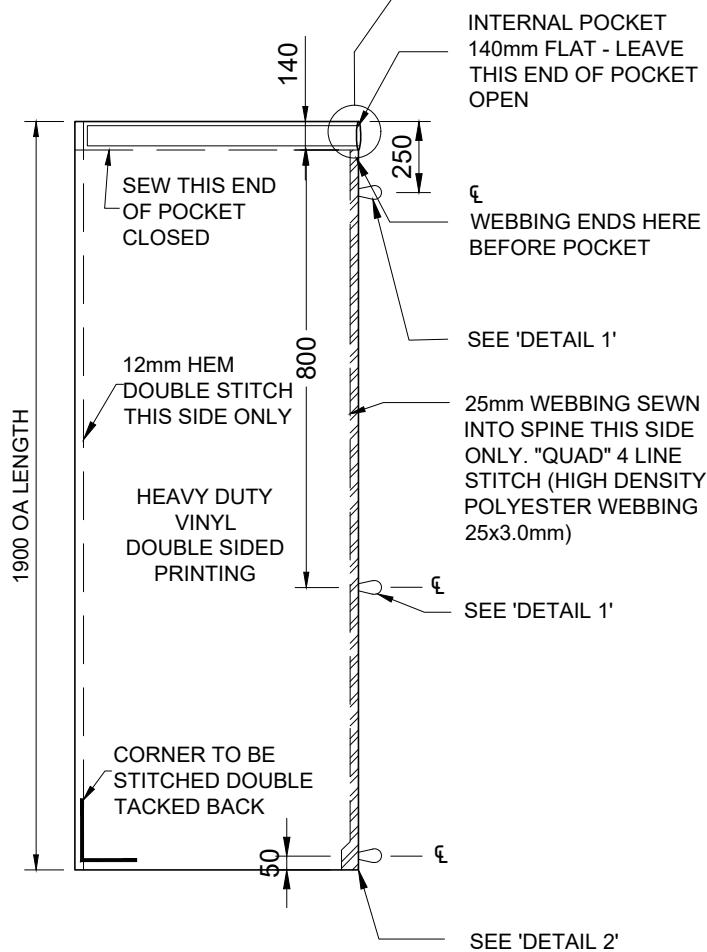
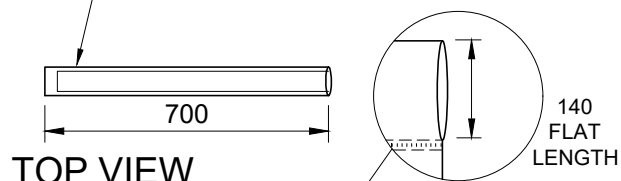

Notes:

1. Tape loops must be attached to resist tensile loads of 50kg ea.
2. Webbing material to be high density polyester webbing 25x3.0mm
3. All dimensions to tape loops are to the centre of tape loop attachment.
4. For General Notes refer *Design and Construction Note 900.01*.